

# HEAVY DUTY STUD TYPE CAM FOLLOWER - NUKRE.. SYLB®

## Stud:

Alloy steel, hardened, ground,  
with grease hole and eccentric collar

## Ring:

Bearing steel, hardened, ground, polished,  
Full complement roller set, with eccentric collar,  
with acalabyrinth seals on both sides

螺栓: 合金钢, 淬火, 磨加工, 有油孔, 带有偏心套

外圈: 轴承钢, 淬火, 磨加工, 抛光, 满滚子配置, 两侧密封

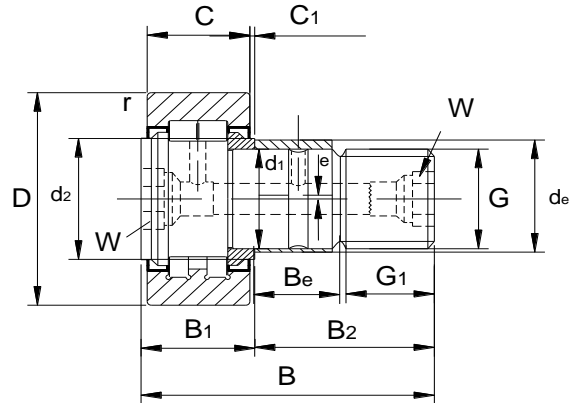

Bearing No. 型号	Dimensions in millimeters 尺寸 mm													Properties 性能							Weight 重量		
	D	d1	B	B1	B2	Be	C	C1	d2	de	e	G	G1	r	W	MA	Crw	Corw	Fr per	For per		Curw	NDG
		h7		max					h9					min	Nm	KN	KN	KN	KN	KN	KN	1/min	≈kg
NUKRE 35	35	16	52	22.6	29.5	12	18	3.8	27.6	20	1	M16×1.5	17	0.6	8	58	15.3	16.8	8.6	16.8	2	6500	0.177
NUKRE 40	40	18	58	24.6	33.5	14	20	3.8	30	22	1	M18×1.5	19	1	8	87	18.4	22.6	13.1	22.6	3	5500	0.258
NUKRE 47	47	20	66	25.6	40.5	18	24	0.8	27	24	1	M20×1.5	21	1	10	120	28	35	16.4	33	4	4200	0.4
NUKRE 52	52	20	66	25.6	40.5	18	24	0.8	31	24	1	M20×1.5	21	1	10	120	29	37.5	17.3	34.5	5	4200	0.47
NUKRE 62	62	24	80	30.6	49.5	22	28	1.3	38	28	1	M24×1.5	25	1	14	220	40	50	23.5	46.5	6	2600	0.824
NUKRE 72	72	24	80	30.6	49.5	22	28	1.3	44	28	1	M24×1.5	25	1.1	14	220	44.5	60	32	60	8	2600	1.05
NUKRE 80	80	30	100	37	63	29	35	1	47	35	1.5	M30×1.5	32	1.1	14	450	69	98	47.5	96	12	1800	1.67
NUKRE 90	90	30	100	37	63	29	35	1	47	35	1.5	M30×1.5	32	1.1	14	450	79	117	77	117	14	1800	2.02

W: Nominal dimension for hexagonal socket

MA: Nut tightening torque

Crw: Effective dynamic load rating as track roller (radial)

Corw: Effective static load rating as track roller (radial)

Fr per: Permissible dynamic radial load

For per: Permissible static radial load

Curw: Fatigue limit load

NDG: Speed (for continuous operation and grease lubrication)

