

**Stud:**

Alloy steel, hardened, ground,  
d1 ≥ 12: with grease hole

**Ring:**

Bearing steel, hardened, ground, polished,  
gap seals on both side

螺栓: 合金钢, 淬火, 磨加工, d1 ≥ 12 有油孔

外圈: 轴承钢, 淬火, 磨加工, 抛光, 两侧间隙密封

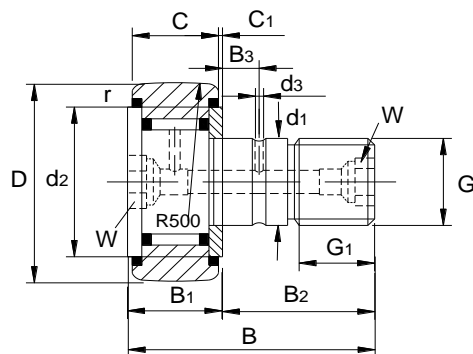

Bearing No.	Dimensions in millimeters													Properties					Weight	
型号	尺寸 mm													性能					重量	
	D	d1	B	B1	B2	B3	C	C1	d2	d3	G	G1	r	W	MA	Crw	Corw	Curw	NDG	
		h7		max							6g		min		Nm	KN	KN	KN	1/min	≈kg
KR 16	16	6	28	12.2	16		11	0.6	12.5		M6×1	8	0.15		3	3.15	3.3	0.41	14,000	0.019
KR 19	19	8	32	12.2	20		11	0.6	15		M8×1	10	0.15		8	3.5	3.9	0.48	11,000	0.029
KR 22	22	10	36	13.2	23		12	0.6	17.5		M10×1	12	0.3	5	15	4.5	5.2	0.65	8,000	0.045
KR 26	26	10	36	13.2	23		12	0.6	17.5		M10×1	12	0.3	5	15	5.1	6.2	0.77	8,000	0.059
KR 30	30	12	40	15.2	25	6	14	0.6	23	3	M12×1	13	0.6	6	22	6.8	8.4	1.07	5,500	0.092
KR 32	32	12	40	15.2	25	6	14	0.6	23	3	M12×1.5	13	0.6	6	22	7.1	8.9	1.14	5,500	0.103
KR 35	35	16	52	19.6	32.5	8	18	0.8	27.6	3	M16×1.5	17	0.6	8	58	9.7	14.1	1.7	3,600	0.173
KR 40	40	18	58	21.6	36.5	8	20	0.8	31.5	3	M18×1.5	19	1	8	87	10.9	15.8	2.9	2,900	0.247

W: Nominal dimension for hexagonal socket

MA: Nut tightening torque

Crw: Effective dynamic load rating as track roller (radial)

Corw: Effective static load rating as track roller (radial)

Curw: Fatigue limit load

NDG: Speed (for continuous operation and grease lubrication)

