

**Stud:**

Alloy steel, hardened, ground,  
d1 ≥ 12: with grease hole

**Ring:**

Bearing steel, hardened, ground, polished,  
with plastic axial plain washers on both sides

**螺栓:** 合金钢, 淬火, 磨加工, d1 ≥ 12 有油孔

**外圈:** 轴承钢, 淬火, 磨加工, 抛光, 两侧塑料推力滑动垫圈

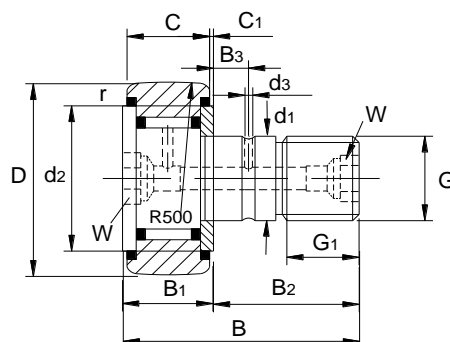

Bearing No. 型号	Dimensions in millimeters 尺寸 mm											Properties 性能						Weight 重量		
	D	d1	B	B1	B2	B3	C	C1	d2	d3	G	G1	r	W	MA	Crw	Corw	Curw	NDG	
		h7		max							6g		min		Nm	KN	KN	KN	1/min	≈kg
KR 16 PP	16	6	28	12.2	16		11	0.6	12.5		M6×1	8	0.15		3	3.15	3.3	0.41	14,000	0.018
KR 16 SK PP	16	6	28	12.2	16		11	0.6	12.5		M6×1	8	0.15	4	3	3.15	3.3	0.41	14,000	0.019
KR 19 PP	19	8	32	12.2	20		11	0.6	15		M8×1	10	0.15		8	3.5	3.9	0.48	11,000	0.029
KR 19 SK PP	19	8	32	12.2	20		11	0.6	15		M8×1.25	10	0.15	4	8	3.5	3.9	0.48	11,000	0.029
KR 22 PP	22	10	36	13.2	23		12	0.6	17.5		M10×1	12	0.3	5	15	4.5	5.2	0.65	8,000	0.043
KR 26 PP	26	10	36	13.2	23		12	0.6	17.5		M10×1	12	0.3	5	15	5.1	6.2	0.77	8,000	0.057
KR 30 PP	30	12	40	15.2	25	6	14	0.6	23	3	M12×1	13	0.6	6	22	6.8	8.4	1.07	5,500	0.088
KR 32 PP	32	12	40	15.2	25	6	14	0.6	23	3	M12×1.5	13	0.6	6	22	7.1	8.9	1.14	5,500	0.98
KR 35 PP	35	16	52	19.6	32.5	8	18	0.8	27.6	3	M16×1.5	17	0.6	8	58	9.7	14.1	1.7	3,600	0.164
KR 40 PP	40	18	58	21.6	36.5	8	20	0.8	31.5	3	M18×1.5	19	1	8	87	10.9	15.8	2.9	2,900	0.239
KR 47 PP	47	20	66	25.6	40.5	9	24	0.8	36.5	4	M20×1.5	21	1	10	120	15.4	26	3.4	2,400	0.381
KR 52 PP	52	20	66	25.6	40.5	9	24	0.8	36.5	4	M20×1.5	21	1	10	120	16.6	29	3.8	2,400	0.454
KR 62 PP	62	24	80	30.6	49.5	11	29	0.8	44	4	M24×1.5	25	1	14	220	26	48	6.8	1,900	0.77
KR 72 PP	72	24	80	30.6	49.5	11	29	0.8	44	4	M24×1.5	25	1.1	14	220	28	53	7.2	1,900	1.01
KR 80 PP	80	30	100	37	63	15	35	1	53	4	M30×1.5	32	1.1	14	450	38.5	77	11	1,300	1.608
KR 90 PP	90	30	100	37	63	15	35	1	53	4	M30×1.5	32	1.1	14	450	40.5	83	11.7	1,300	1.975

W: Nominal dimension for hexagonal socket

MA: Nut tightening torque

Crw: Effective dynamic load rating as track roller (radial)

Corw: Effective static load rating as track roller (radial)

Curw: Fatigue limit load

NDG: Speed (for continuous operation and grease lubrication)